



77555 NORTHBROOK

Popular Configurations

Note: Always assemble configurations from right hand facing to left hand facing components.

How We Measure

Height - measured from the highest point of the back pillow to the floor.

Depth - measured from the front edge of the seat cushion to the top of the back.

Width - measured from the widest point of the arm or arm pillow to the widest point of the opposite arm or arm pillow.

Arm Height - measured from the top of the arm to the floor.

Seat Height - measured from the crown of the seat cushion to the floor.

Warranty

Wood Frames, Springs or Webbing - ten year warranty

Metal Frames - two year warranty under normal household use

Motion Reclining Mechanisms - seven year warranty

Reclining Chairs, Sofabed Mechanisms and Sofabed Mattresses - two year warranty

Seat Cushion Foam and Fibre-filled Components - five year pro-rated warranty

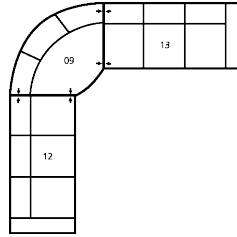

CONFIGURATION CA
133 x 133"
338 x 338cm

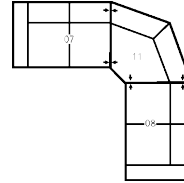

CONFIGURATION CB
103 x 103"
262 x 262cm

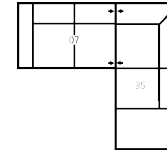

CONFIGURATION CE
94 x 85"
239 x 216cm

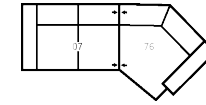

CONFIGURATION CL
115 x 62"
292 x 157cm

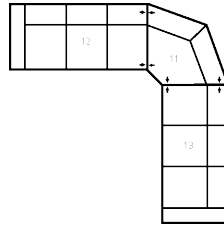

CONFIGURATION C0
127 x 127"
323 x 323cm

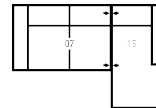

CONFIGURATION C1
91 x 62"
231 x 157cm

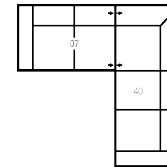

CONFIGURATION C2
94 x 94"
239 x 239cm

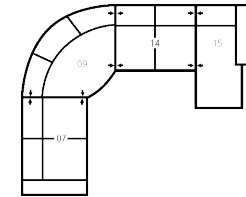

CONFIGURATION C4
133 x 110"
338 x 279cm

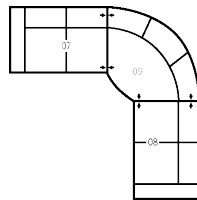

CONFIGURATION C7
110 x 110"
279 x 279cm

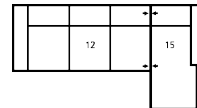

CONFIGURATION C8
114 x 62"
290 x 157cm

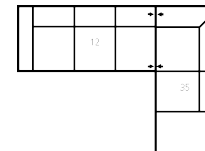

CONFIGURATION C9
117 x 85"
297 x 216cm