

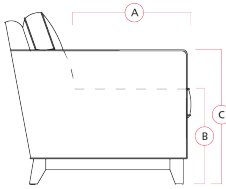

# 77555 NORTHBROOK

Dimensions shown as Width x Depth x Height. Specifications are correct at time of printing and are subject to change without notice.  
LHF - left hand facing RHF - right hand facing IA - inside arm to inside



## Dimensions

A - Seat Depth - 20.5" / 52cm

B - Seat Height - 19" / 48cm

C - Arm Height - 24" / 61cm

## Features

- Hardwood, softwood and engineered wood products; all joints pinned & glued for uniformity & strength
- Back: 11 or 12 gauge sinuous springs which are engineered to provide lasting comfort and strength
- Seat: Interwoven 100% elastic webbing offers consistent suspension for the life of the product
- Back filled with blown fibre

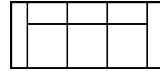

01 Sofa  
94 x 37 x 38"  
239 x 94 x 97cm  
IA: 67" / 170cm



10 Armless Chair  
24 x 37 x 38"  
61 x 94 x 97cm

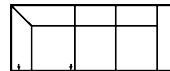

40 RHF Sofa Split  
39 LHF Sofa Split  
94 x 37 x 38"  
239 x 94 x 97cm



02 Chair  
48 x 37 x 38"  
122 x 94 x 97cm  
IA: 21" / 53cm

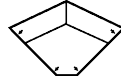

11 Corner Square  
46 x 46 x 38"  
117 x 117 x 97cm

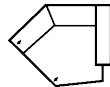

76 RHF Nest  
77 LHF Nest  
60 x 48 x 38"  
152 x 122 x 97cm

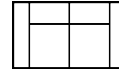

03 Loveseat  
68 x 37 x 38"  
173 x 94 x 97cm  
IA: 44" / 112cm

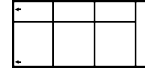

13 RHF Sofa  
12 LHF Sofa  
80 x 37 x 38"  
203 x 94 x 97cm



04 Ottoman  
35 x 25 x 18"  
89 x 64 x 46cm



14 Armless Loveseat  
47 x 37 x 38"  
119 x 94 x 97cm

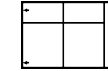

08 RHF Loveseat  
07 LHF Loveseat  
57 x 37 x 38"  
145 x 94 x 97cm

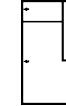

15 RHF Chaise  
16 LHF Chaise  
34 x 62 x 38"  
86 x 157 x 97cm

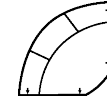

09 Corner Curve  
53 x 53 x 38"  
135 x 135 x 97cm

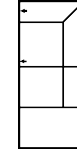

35 RHF Corner Chaise  
36 LHF Corner Chaise  
85 x 37 x 38"  
216 x 94 x 97cm



# 77555 NORTHBROOK

## Popular Configurations

Note: Always assemble configurations from right hand facing to left hand facing components.

### How We Measure

**Height** - measured from the highest point of the back pillow to the floor.

**Depth** - measured from the front edge of the seat cushion to the top of the back.

**Width** - measured from the widest point of the arm or arm pillow to the widest point of the opposite arm or arm pillow.

**Arm Height** - measured from the top of the arm to the floor.

**Seat Height** - measured from the crown of the seat cushion to the floor.

### Warranty

**Wood Frames, Springs or Webbing** - ten year warranty

**Metal Frames** - two year warranty under normal household use

**Motion Reclining Mechanisms** - seven year warranty

**Reclining Chairs, Sofabed Mechanisms and Sofabed Mattresses** - two year warranty

**Seat Cushion Foam and Fibre-filled Components** - five year pro-rated warranty

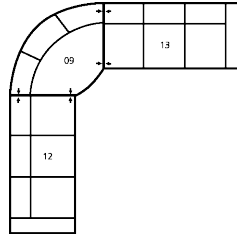

**CONFIGURATION CA**  
133 x 133"  
338 x 338cm

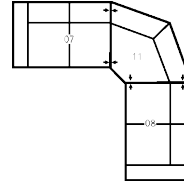

**CONFIGURATION CB**  
103 x 103"  
262 x 262cm

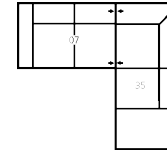

**CONFIGURATION CE**  
94 x 85"  
239 x 216cm

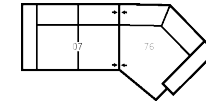

**CONFIGURATION CL**  
115 x 62"  
292 x 157cm

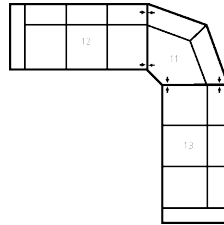

**CONFIGURATION C0**  
127 x 127"  
323 x 323cm

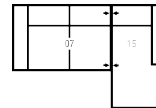

**CONFIGURATION C1**  
91 x 62"  
231 x 157cm

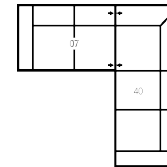

**CONFIGURATION C2**  
94 x 94"  
239 x 239cm

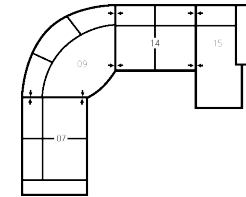

**CONFIGURATION C4**  
133 x 110"  
338 x 279cm

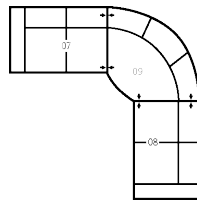

**CONFIGURATION C7**  
110 x 110"  
279 x 279cm

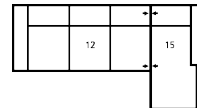

**CONFIGURATION C8**  
114 x 62"  
290 x 157cm

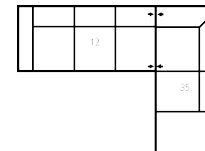

**CONFIGURATION C9**  
117 x 85"  
297 x 216cm