



PAC-MAN AIR HOCKEY

Air Hockey Table Owner's Manual.

Assembly, operation and care instructions.

Contents

| | |
|---|----|
| Foreword | 2 |
| Product Specifications..... | 3 |
| Before Assembling..... | 4 |
| Tools required for Assembling*..... | 4 |
| Product Parts | 5 |
| 1. For Legs | 5 |
| 2. For Protection Acrylic..... | 5 |
| 3. For Player | 6 |
| Assembly Procedures | 7 |
| Safety Instructions for Use and Play | 11 |
| Hardware and Software Configuration..... | 12 |
| Hardware Descriptions..... | 12 |
| Hardware Specifications | 13 |
| Software Specifications..... | 14 |
| Menu Diagram: | 15 |
| Parts..... | 16 |
| Cabinet parts..... | 16 |
| Cash Box and Tickets Parts (Arcade Version Only)..... | 17 |
| Electronics..... | 18 |
| Decal Prints | 19 |
| Consumable Parts..... | 20 |

Foreword

We would like to thank you very much for purchasing the Pac-Man Air Hockey from Bandai Namco Amusement America Inc.

For your own safety, please read through this instruction manual that we have prepared for you thoroughly, and take precautions when using the product. We hope that you will become accustomed to the product quickly.

Product Specifications

Electrical Power (MANUAL SELECT)

Domestic 120 VAC @ 60 Hz, 5 amps

International 240 VAC @ 50 Hz, 2.5 amps

Temperature

32° to 100° Fahrenheit

Humidity

Must not exceed 95% relative humidity

Assembled “Pac-Man Air Hockey” Dimensions

Width – 48,5”

Depth – 88”

Height – 37”

Weight Assembled ~360 lbs.

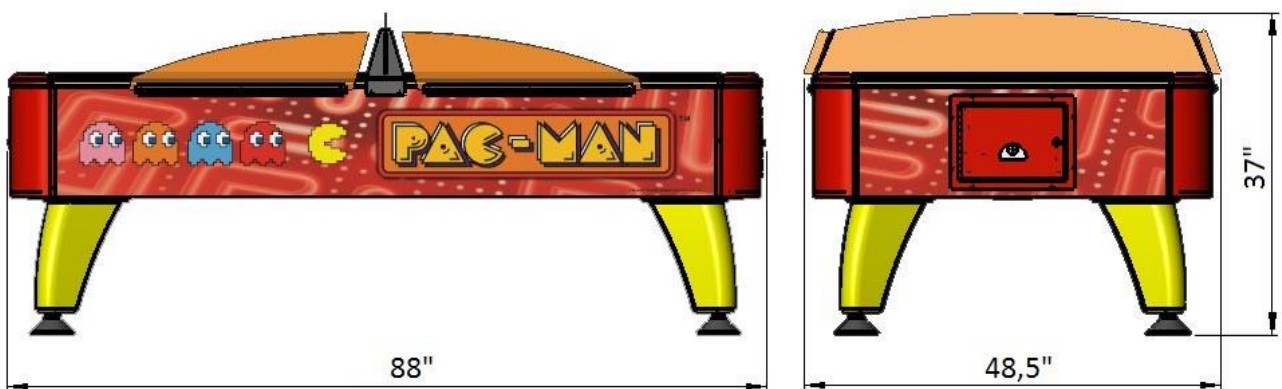

Before Assembling



WARNING

THIS TABLE WEIGHS 360 POUNDS

1. Please make sure you have at least 4 strong adults to assist with assembly and installation*.

**Note: Bandai Namco Amusement America accepts no responsibility for any injury that may result from the assembly, installation or moving of this product.*

2. Inspect to make sure all the parts are included and not damaged.
3. Prior to assembly, you must ensure there is sufficient space for placing or shifting this product.

Tools required for Assembling*

- Pac Man Air Hockey Manual
- Scissors
- Hex Allen Key - 4mm (located inside the bag manual)

**Note: Prepare the above specified tools. Be careful not to damage the product while using these tools*

Product Parts

1. For Legs

- 4 Pac-Man Plastic Legs
- 4 Adjustable Leg Levelers
- 24 Roundhead screws M6 x 35mm
- 24 Split Lock washers M6
- 24 Flat washers M6



2. For Protection Acrylic

- 2 Steel Locker central protection acrylic
- 4 side protection acrylic
- 1 central protection acrylic
- 16 Roundhead screws M6 x 35mm

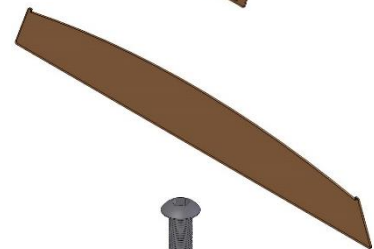
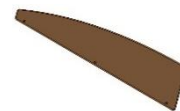

3. For Player

- 2 doors keys



- 1 AC Power cord



- 2 pucks



- 2 mallets



Assembly Procedures

1. Use scissors or a knife to cut* through the packing tape.

****Note: Do not cut too deep or you will damage the unit.***

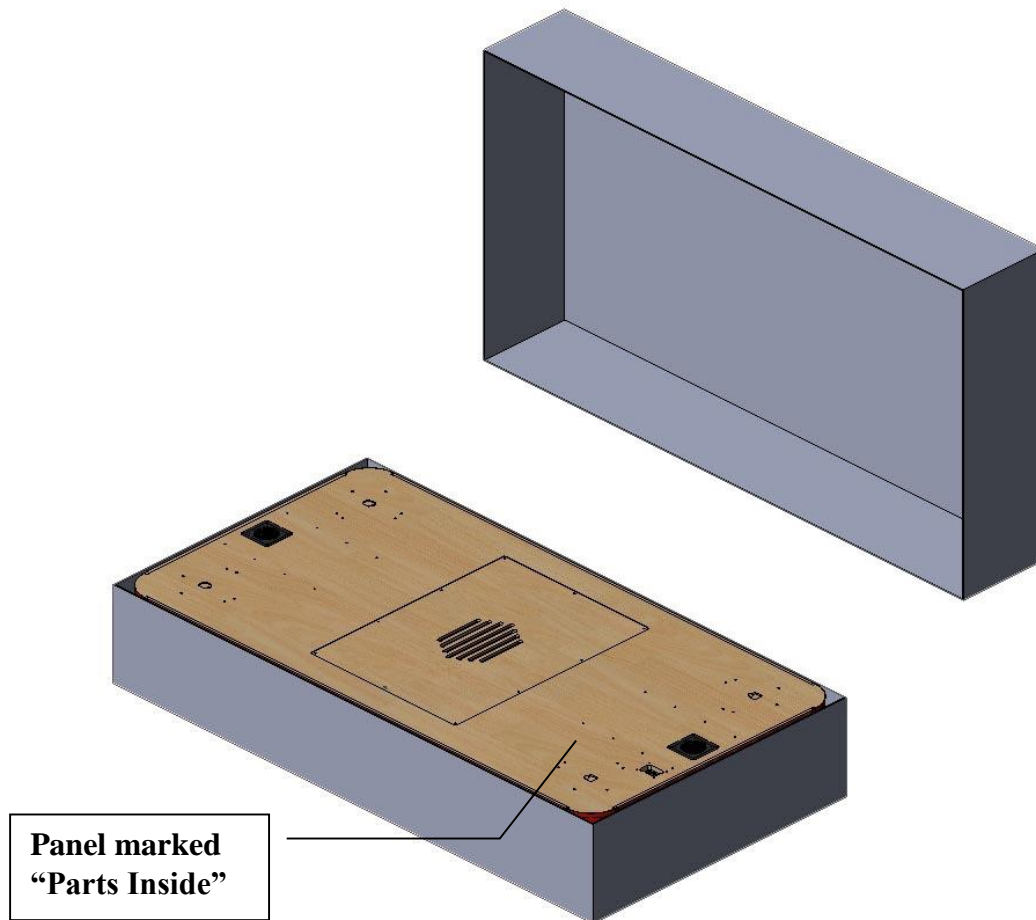

2. Open the carton, make sure the wooden side of the Pac-Man Air Hockey is facing up.
3. Use Hex Allen Key - 4mm to unscrew the 10 screws on the panel with the sticker "Parts Inside" on it. Once the panel is opened, please take out the parts* indicated on page 5 and 6.

****Note: Do not remove Air Blower***

4. Take out the 4 Pac Man Air Hockey plastic legs and screw the adjustable leg levelers into the base of the legs.

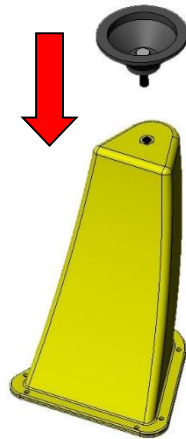

5. Place the legs on the bottom surface of the table. Ensure alignment and then attach with roundhead screws M6 x 35mm and split lock washer M6 and flat washer M6

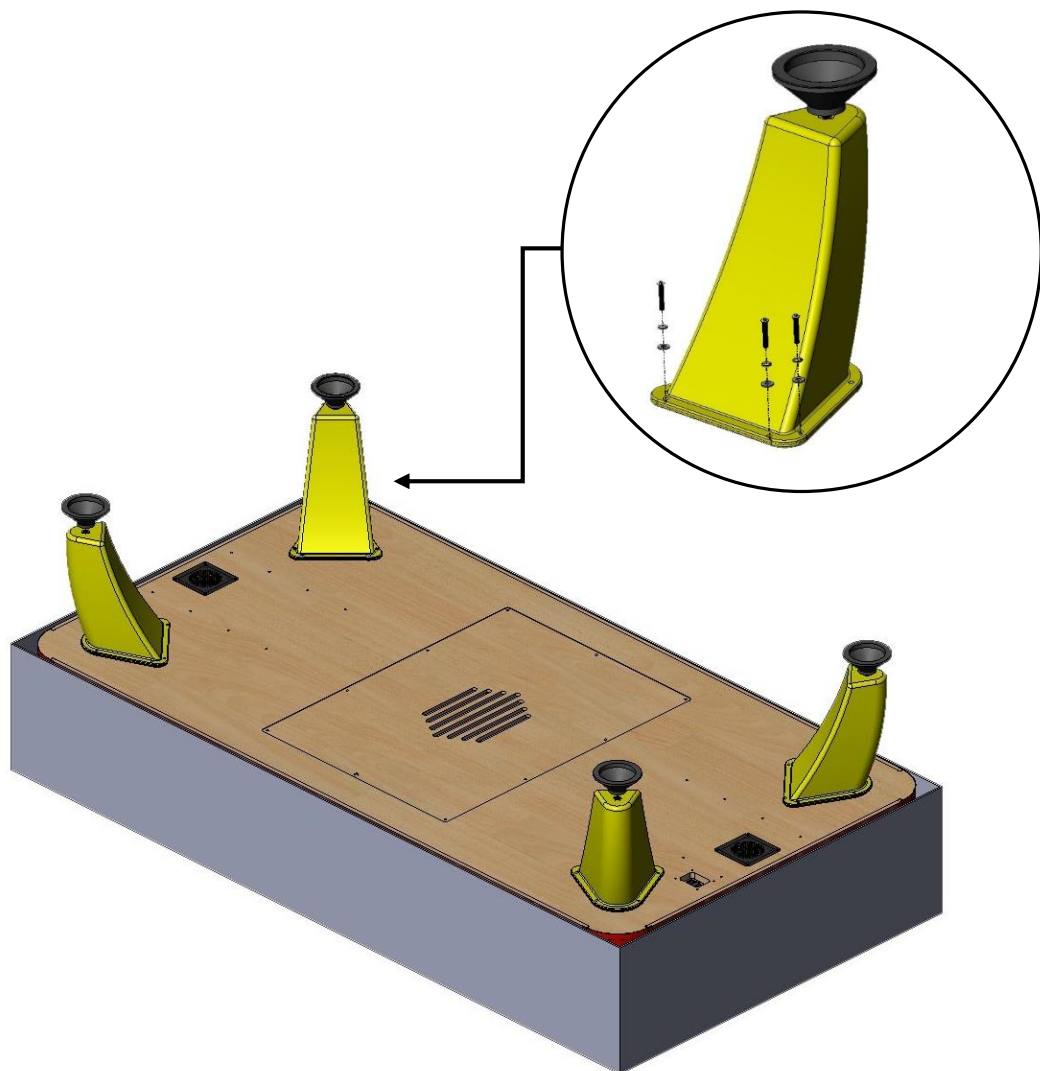

6. Plug in the AC Power Cord

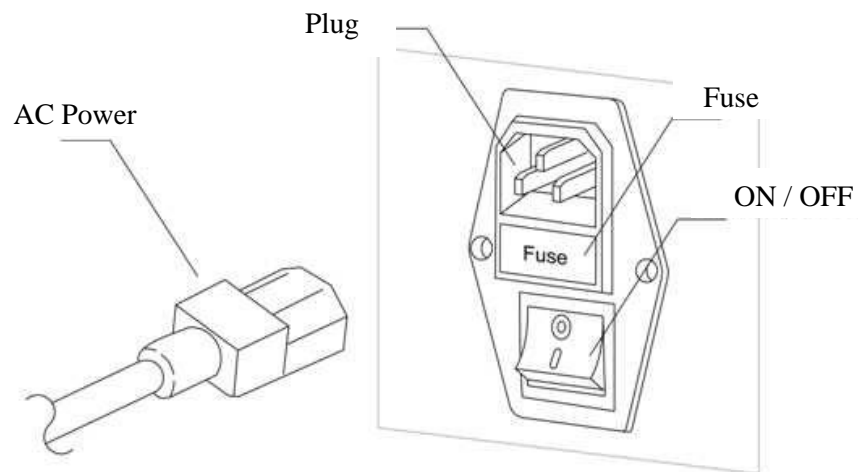

7. Ensure all legs are tightly attached then flip the table 90 degrees keeping the cardboard top on to prevent scratching. This action requires 4 people. Please make sure you have at least 4 strong adults to assist with assembly and installation. Flip it another 90 degrees to place the legs on the ground.



- Using 2 steel locker central protection, assemble the central protection acrylic. Ensure alignment and then attach with 4 roundhead screws M6 x 35mm.

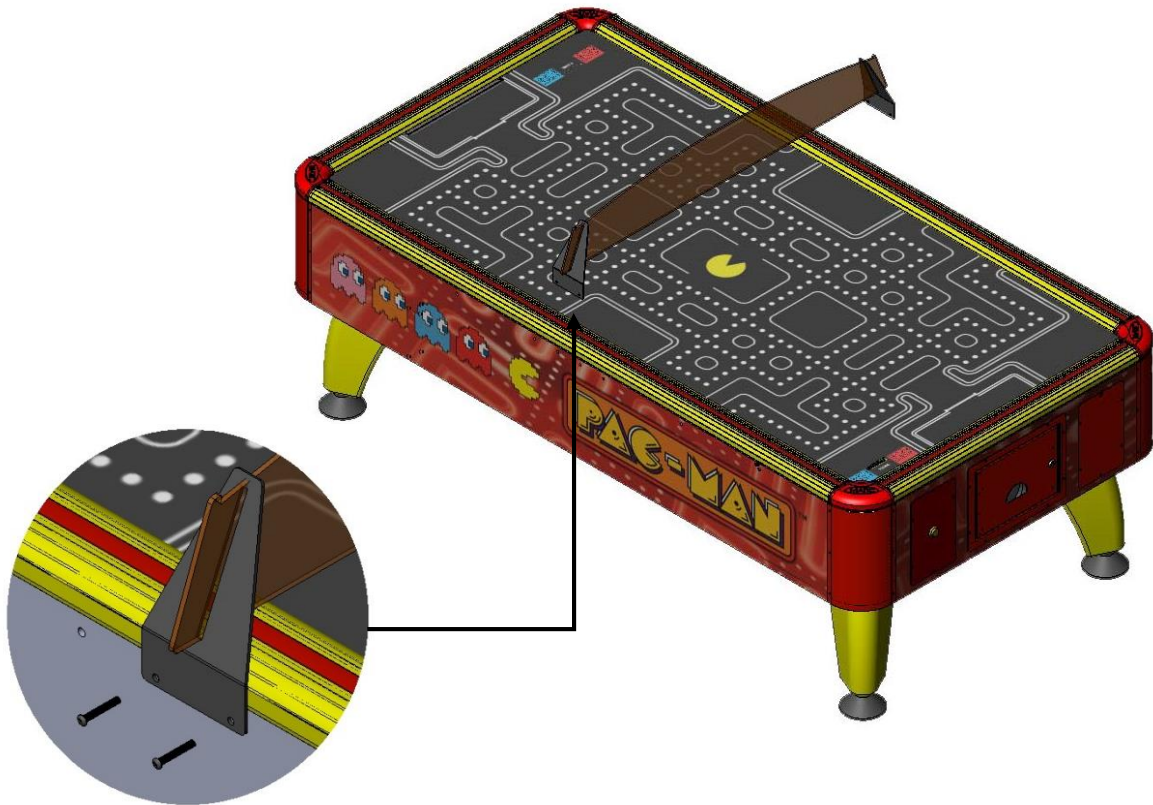

- Assemble the side protection acrylic. Ensure alignment and then attach with 3 roundhead screws 6 x 35mm, each piece.

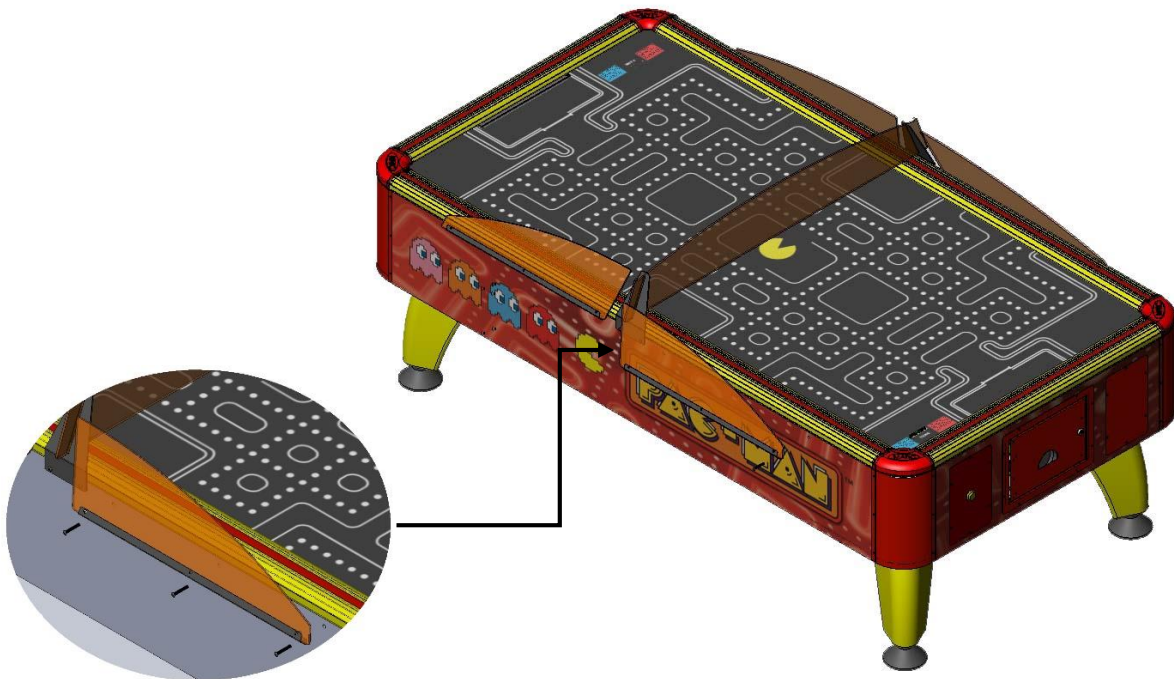

Safety Instructions for Use and Play



Risk of Electric Shock

- Hazardous voltage, which can cause electrical shock, exists inside the equipment. Only qualified personnel should work inside the equipment.



Playing Warnings

- Do not hit the puck with the mallet when the puck is not level and flat.
- Spectators should not stand by the side of the table. This may cause injury.
- Hold the mallet by the handle and not the base or the puck may hit fingers.
- This game features flashing lights, which may not be suitable for photosensitive epilepsy.

Hardware and Software Configuration

First, ensure the power is off. Open the door with a key. Hold the panel's handle and pull it out until half of the power panel is exposed.

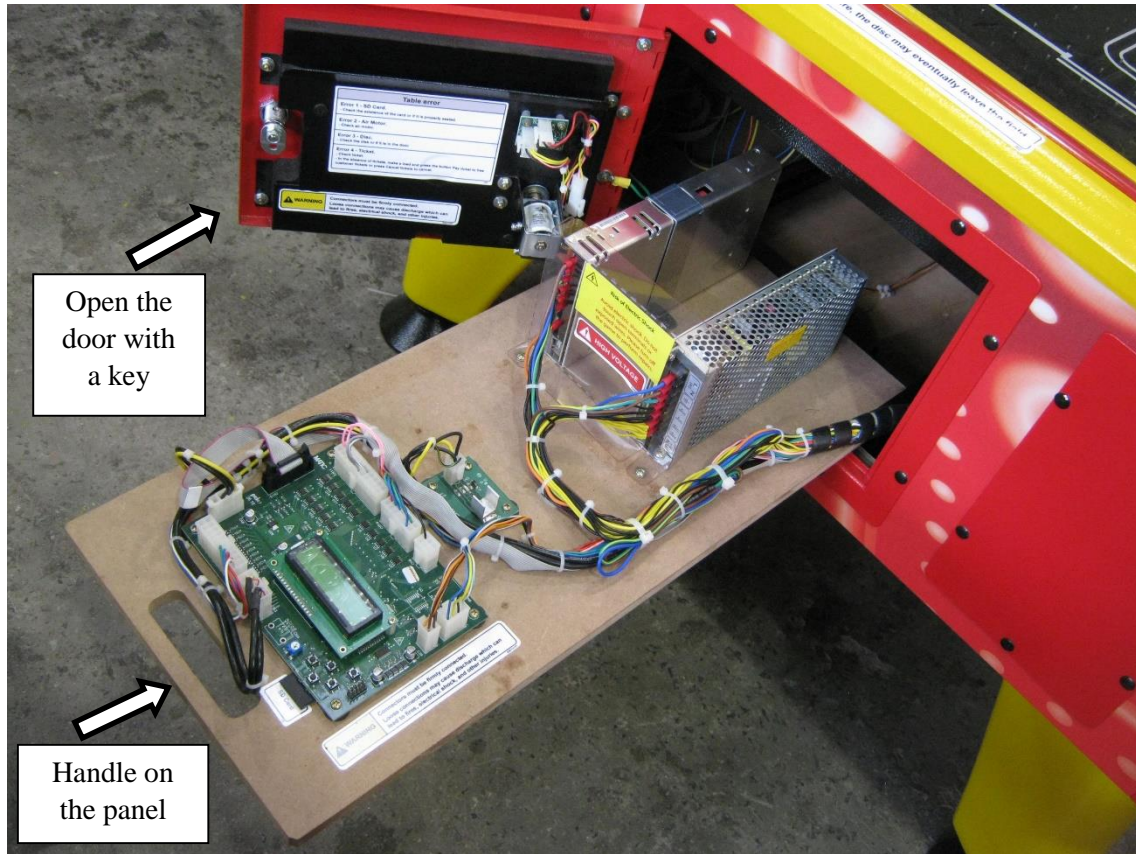

Hardware Descriptions

Note: Do not touch open terminals or exposed wires while the game is on. Risk of electric shock.

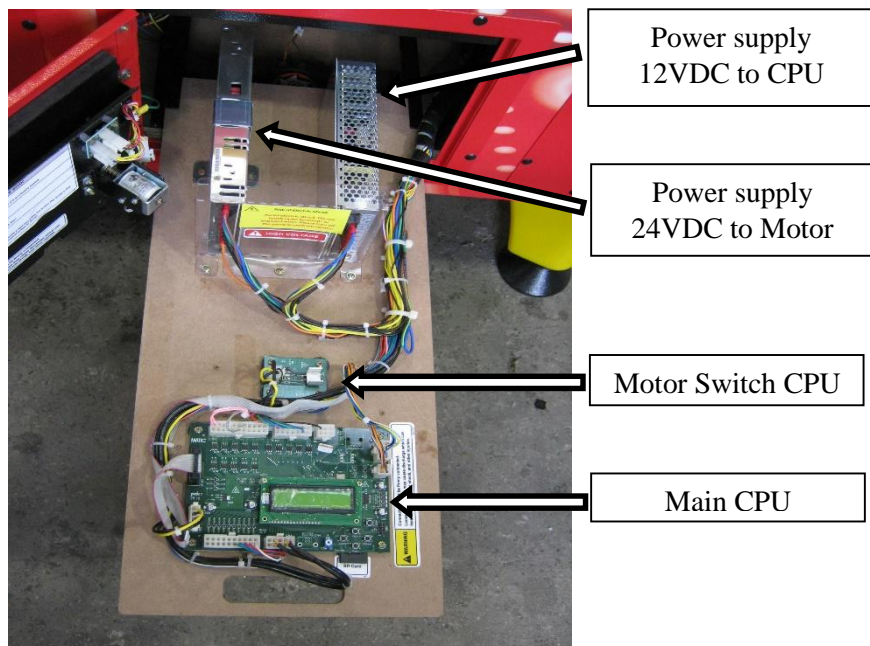

Hardware Specifications

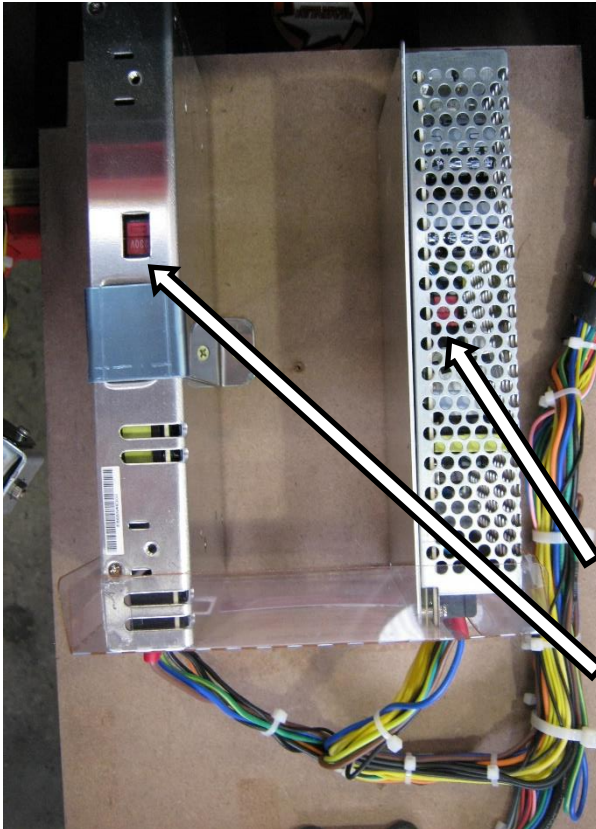

Risk of Electric Shock

Avoid electric shock. Do not touch open terminals or exposed wires. Please turn off the game to perform repairs.

Hazardous voltage, which can cause electrical shock, exists inside the equipment. Only qualified personnel should work inside the equipment.



Warning

Machine is shipped set to 120 Volts, if operating this machine in an area that uses 220 Volts, both power supplies must be changed or severe damage will occur.

To change the voltage, swipe the red switch inside the both power supplies.

Power Supply

Provides power to all internal components, such as the motherboard, coin mechanism, motor. etc. The +12 VDC and +24VDC are separated to ensure no interference to components when one has an insufficient supply or an unstable supply of power.

Note: +24 VDC is on the left +12 VDC is on the right

Motor PCB

Motor PCB switches the blower motor on and off. When the green LED is on, the motor is on! Main PCB control the motor PCB.

Main PCB

Controls the operation of all internal components. Malfunctions or errors with any of the components can be diagnosed by looking at the DISPLAY indicators on the main PCB.

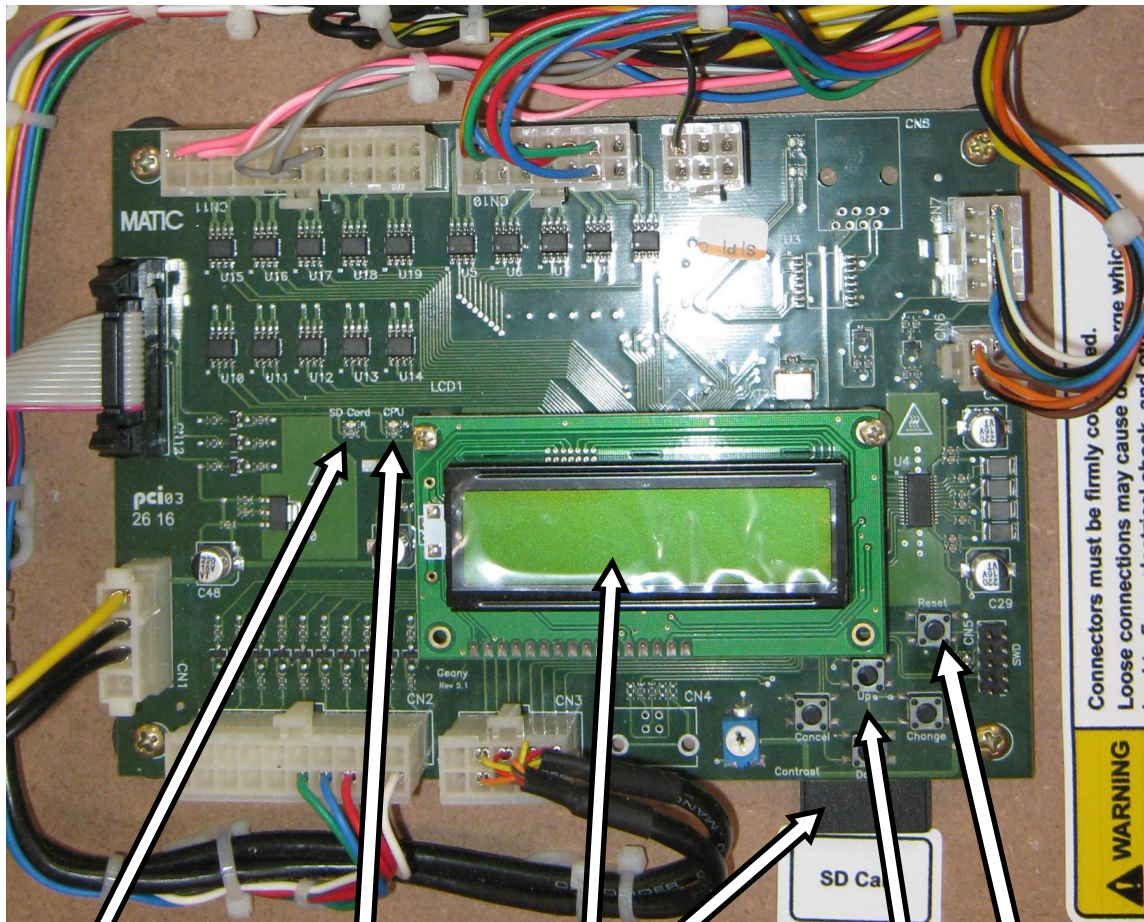

- | | | | | |
|----------------------------------|-----------------------------------|-------------------|---------------------|----------------------------|
| LED is lit if SD Card is reading | LED is lit if main PCB is working | Display & SD CARD | MENU 4 push buttons | RESET Restart the Main PCB |
|----------------------------------|-----------------------------------|-------------------|---------------------|----------------------------|

Software Specifications

- Short Menu:
 - i. Press up to set VOLUME IN GAME, adjust the volume using up and down then press change for complete.
 - ii. Press down to set VOLUME DEMO, adjust the volume using up and down then press change for complete.

- Complete Menu:

Press change to enter menu, up and down to choose options, cancel to return.

Menu Diagram:

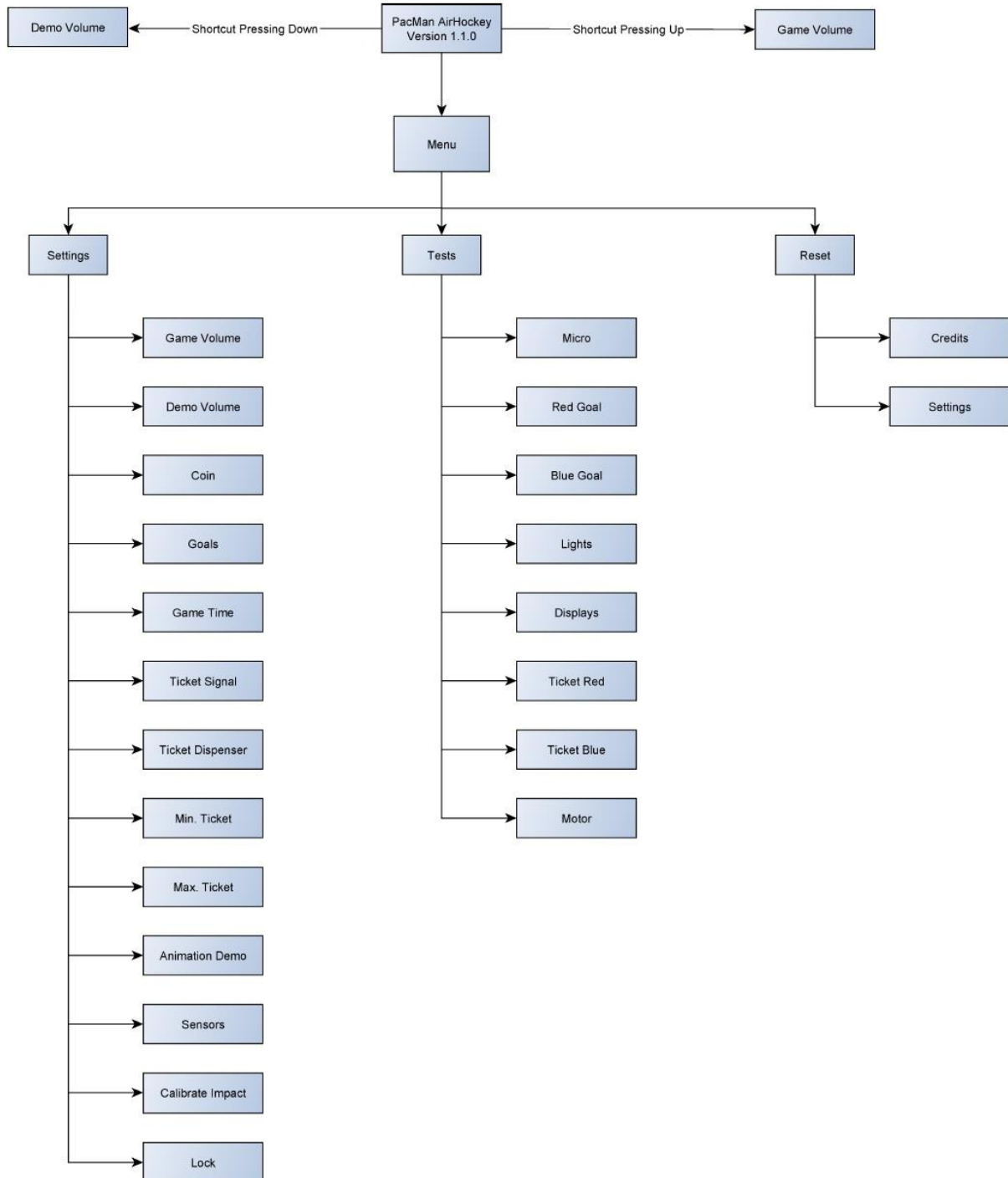

Parts

Cabinet parts

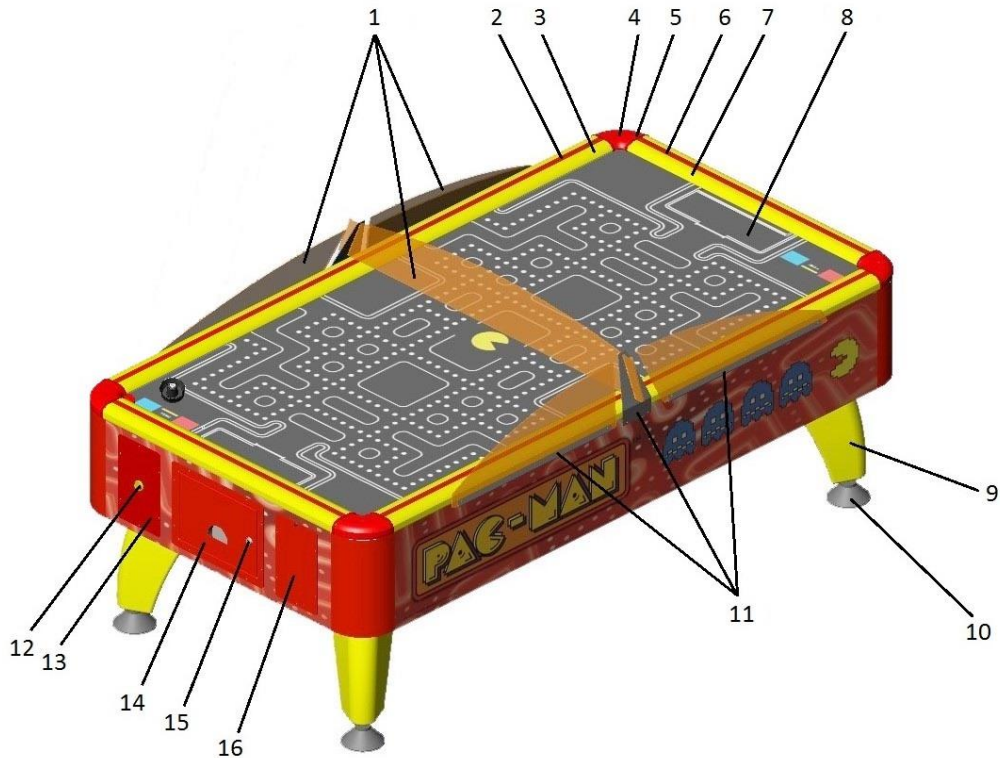

| Ref | Part Description | Part# |
|-----|--|--------------------|
| 1 | Protection Acrylic Set | AH90-68-000-258-00 |
| | Protection Acrylic Center | AH90-68-000-258-99 |
| | Protection Acrylic Left | AH90-68-000-258-98 |
| | Protection Acrylic Right | AH90-68-000-258-97 |
| 2 | Side Red Rubber Perimeter Rail Trim | AH96-68-000-256-00 |
| 3 | Side Aluminum Rail | AH10-31-002-070-00 |
| 4 | Red Plastic Corner | AH90-55-000-142-00 |
| 5 | Red Corner Finishing | AH90-55-000-146-00 |
| 6 | End Red Rubber Perimeter Rail Trim | AH96-68-000-257-00 |
| 7 | End Aluminum Rail | AH90-31-002-069-00 |
| 8 | Acrylic Play Field 10MM "Pac Man Air Hockey" | AH40-21-000-957-00 |
| 9 | Leg "Pac Man Air Hockey" | AH10-57-000-035-00 |
| 10 | Leg Leveler | AH20-31-000-095-00 |
| 11 | Protection Bracket Set | AH05-68-000-259-00 |
| | Protection Bracket Left/Right | AH05-68-000-259-99 |
| | Protection Bracket Center | AH05-68-000-259-98 |
| 12 | Yellow Push Button | AH53-60-000-064-00 |
| 13 | Cover Plate with Hole for Push Button | AH10-31-002-122-00 |
| 14 | Complete Door Set "Pac Man Air Hockey" | AH05-68-000-252-00 |
| 15 | Lock | AH26-64-700-006-00 |
| 16 | Cover Plate | AH10-31-002-109-00 |

Cash Box and Tickets Parts (Arcade Version Only)

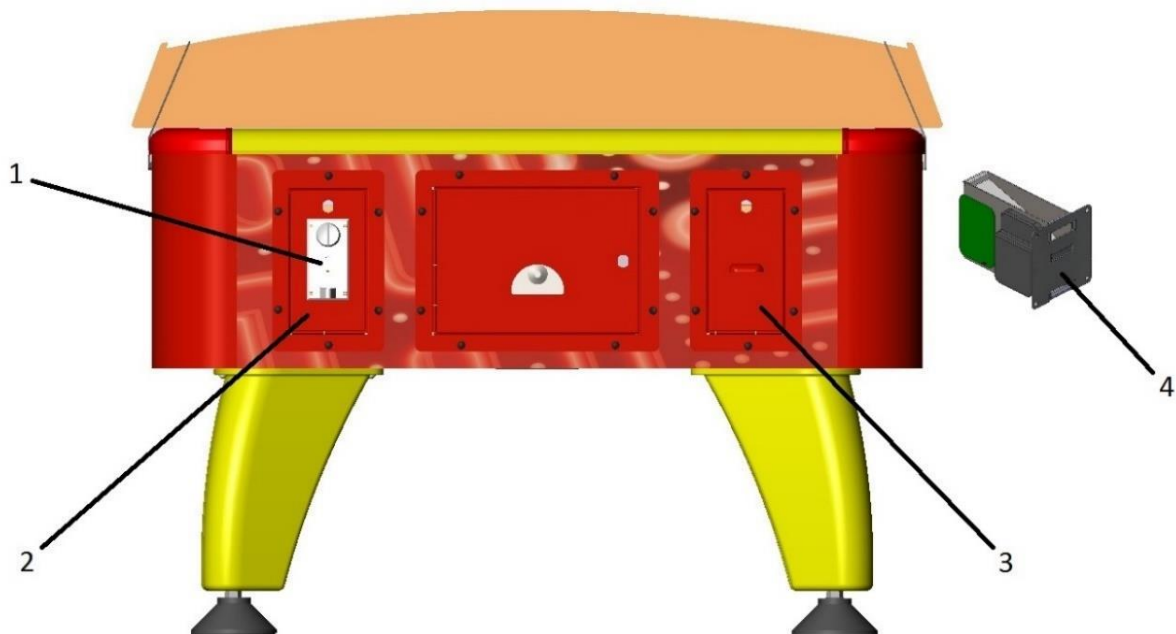

| Ref | Part Description | Part# |
|------------|---------------------------|--------------------|
| 1 | Coin Acceptor | AH83-42-400-042-00 |
| 2 | Coin Door Assembly | AH83-68-000-253-00 |
| 3 | Ticket Door Assembly | AH83-68-000-254-00 |
| 4 | TL-002IV Ticket Dispenser | AH82-42-400-106-00 |

Electronics

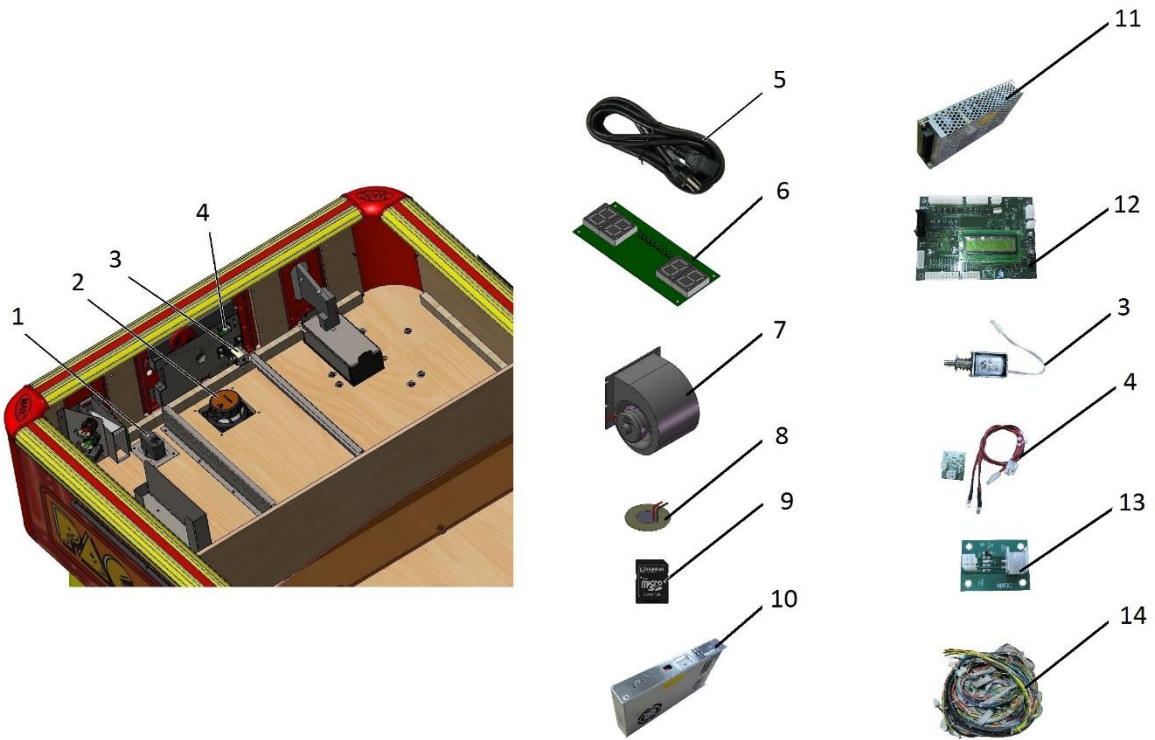

| Ref | Part Description | Part# |
|-----|---|--------------------|
| 1 | Line Filter 125/250 VCA 6A | AH78-42-500-007-00 |
| 2 | Speaker 4" 40W 4 OHMS | AH54-40-000-032-00 |
| 3 | Solenoid Matic 12V HST-100.1 12VCC-100% | AH36-42-400-107-00 |
| 4 | Optical Goal Sensor | AH79-68-000-255-00 |
| 5 | Power Cord 6 feet | AH51-40-200-104-06 |
| 6 | Display PCB "Air Rev. 1" | AH15-41-700-062-00 |
| 7 | Blower | AH58-40-000-009-00 |
| 8 | Rail Sensor Chip "Piezoelectric" 27MM 30V | AH75-40-600-003-00 |
| 9 | SD Card with Software "Pac Man Air Hockey" | AH15-43-000-036-00 |
| 10 | Power Supply 24V 150W "Meanwell LRS-350-24" | VG88-16287-00 |
| 11 | Power Supply 12V 150W "Meanwell RS-150-12" | VG88-14591-00 |
| 12 | Main PCB "Geany Rev. 5.1" | AH15-43-000-035-00 |
| 13 | Motor PCB "Motor Rev.1" | AH15-41-700-064-00 |
| 14 | Complete Harness "Pac Man Air Hockey (EXP)" | AH50-40-100-110-00 |

Decal Prints



| Ref | Part Description | Part# |
|-----|---|--------------------|
| 1 | Decal Set Complete (4 pieces) | AH40-68-000-260-00 |
| | Decal Side (Colorful Ghost's) | AH40-68-000-260-99 |
| | Decal Side (Blue Ghost's) | AH40-68-000-260-98 |
| | Decal End | AH40-68-000-260-97 |
| 2 | Security Decal Set "Pac Man Air Hockey" | AH40-68-000-261-00 |

Consumable Parts



| Ref | Part Description | Part# |
|-----|------------------|--------------------|
| 1 | Puck (Red) | AH95-55-000-016-00 |
| 2 | Mallet | AH90-68-000-039-00 |



© BANDAI NAMCO Amusement America Inc.

First Edition Published in October 2016

BANDAI NAMCO AMUSEMENT AMERICA INC.

951 Cambridge Drive

Elk Grove Village, IL 60007

847.264.5610

FAX: 847.264.5611

Technical Assistance (USA)

Parts: 847.264.5612 Tech Service: 847.264.5614

Fax: 847.264.5613

Part No. AH45-17059-00

Specifications of the machine and contents of this operation manual are subject to change without prior notice due to product improvements.