

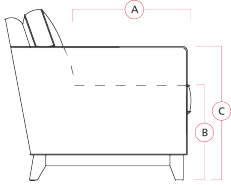

# 77332 MARYMOUNT

Dimensions shown as Width x Depth x Height. Specifications are correct at time of printing and are subject to change without notice.  
LHF - left hand facing RHF - right hand facing IA - inside arm to inside



## Dimensions

- A - Seat Depth - 22" / 56cm
- B - Seat Height - 21" / 53cm
- C - Arm Height - 26.5" / 67cm

## Features

- Hardwood, softwood and engineered wood products; all joints pinned & glued for uniformity & strength
- Back: Premium elastic webbing offers consistent suspension for the life of the product
- Seat: Interwoven 100% elastic webbing offers consistent suspension for the life of the product
- Back filled with blown fibre

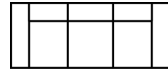

01 Sofa  
83 x 38 x 34"  
211 x 97 x 86cm  
IA: 69" / 175cm



02 Chair  
37 x 38 x 34"  
94 x 97 x 86cm  
IA: 23" / 58cm

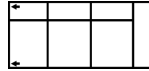

03 Loveseat  
60 x 38 x 34"  
152 x 97 x 86cm  
IA: 46" / 117cm



04 Ottoman  
23 x 23 x 17"  
58 x 58 x 43cm



08 RHF Loveseat  
07 LHF Loveseat  
53 x 38 x 34"  
135 x 97 x 86cm



09 Corner Curve  
49 x 49 x 34"  
124 x 124 x 86cm

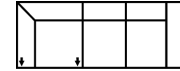

10 Armless Chair  
23 x 38 x 34"  
58 x 97 x 86cm

13 RHF Sofa  
12 LHF Sofa  
76 x 38 x 34"  
193 x 97 x 86cm

14 Armless Loveseat  
46 x 38 x 34"  
117 x 97 x 86cm

15 RHF Chaise  
16 LHF Chaise  
31 x 60 x 34"  
79 x 152 x 86cm

35 RHF Corner Chaise  
36 LHF Corner Chaise  
83 x 38 x 34"  
211 x 97 x 86cm

40 RHF Sofa Split  
39 LHF Sofa Split  
90 x 38 x 34"  
229 x 97 x 86cm



# 77332 MARYMOUNT

## Popular Configurations

Note: Always assemble configurations from right hand facing to left hand facing components.

### How We Measure

**Height** - measured from the highest point of the back pillow to the floor.

**Depth** - measured from the front edge of the seat cushion to the top of the back.

**Width** - measured from the widest point of the arm or arm pillow to the widest point of the opposite arm or arm pillow.

**Arm Height** - measured from the top of the arm to the floor.

**Seat Height** - measured from the crown of the seat cushion to the floor.

### Warranty

**Wood Frames, Springs or Webbing** - ten year warranty

**Metal Frames** - two year warranty under normal household use

**Motion Reclining Mechanisms** - seven year warranty

**Reclining Chairs, Sofabed Mechanisms and Sofabed Mattresses** - two year warranty

**Seat Cushion Foam and Fibre-filled Components** - five year pro-rated warranty

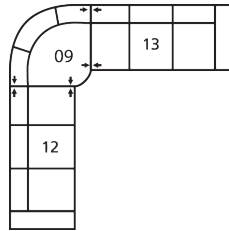

**CONFIGURATION CA**

125 x 125"

318 x 318cm

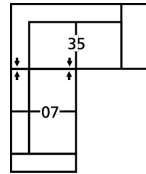

**CONFIGURATION CE**

91 x 83"

231 x 211cm

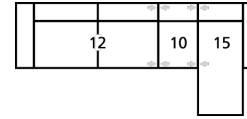

**CONFIGURATION CF**

130 x 60"

330 x 152cm

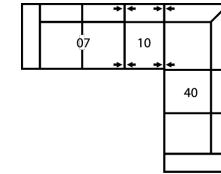

**CONFIGURATION CH**

114 x 89"

290 x 226cm



**CONFIGURATION CK**

198 x 38"

503 x 97cm

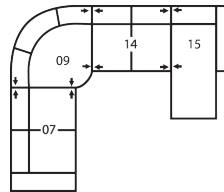

**CONFIGURATION C4**

126 x 102"

320 x 259cm

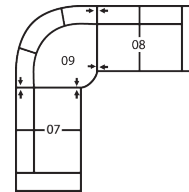

**CONFIGURATION C7**

102 x 102"

259 x 259cm

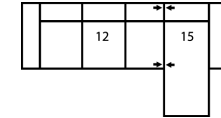

**CONFIGURATION C8**

107 x 60"

272 x 152cm

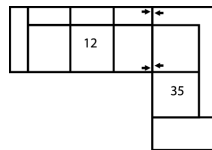

**CONFIGURATION C9**

114 x 83"

290 x 211cm

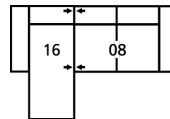

**CONFIGURATION C1**

84 x 60"

213 x 152cm

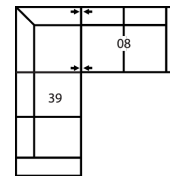

**CONFIGURATION C2**

91 x 89"

231 x 226cm